

**Sight 'n Sound at the
Twelve Apostles Hotel**

Tel: +27 21 448 4094

bookings@sightnsound.co.za

www.sightnsound.co.za

Milkwood



Conference & Banqueting



The Twelve Apostles Hotel and spa, situated in one of the Western Cape's most unique marine reserves, is the perfect choice for a special occasion, whether it is the romance and intimacy of a wedding, or a company's conference/ boardroom meeting or incentive. Offering a selection of fully air-conditioned, state of the art meeting rooms, the tranquil settings, in-tune with their beautiful surroundings, are sure to motivate and inspire any event.

The screen configuration includes either a 2.4m x 1.8m(8' x 6') permanently installed retractable screen centered to the venue set up for either Milkwood 1 or 2; alternatively both venues can be combined. A corporate lectern can be used as a static docking station for a laptop which can accommodate a goose neck microphone that is standard with all PA systems, a power outlet, a VGA com port projector connection and can be operated by means of remote clicker mouse or by a technician.



The Milkwood room has a semi-permanent automated AV installation with all wiring for projection and public address systems imbedded in the venue. With a ceiling mounted projector and fully comprehensive interface it allows for maximum usage of space and an aesthetic finish. Alternatively this venue ideally lends itself to the use of a 42" LCD monitor for minimal reflection and a high definition presentation. A comfort monitor of either 19 or 42inches can also be installed. The full AV set-up can be run on a dedicated un-interrupted power supply.



This venue is ideal for an office set-up including conference calls with both wired and wireless internet connectivity. You may also consider the use of a high volume fax/printer or create a small office network in this cozy, professional environment with its adjoining conservatory and stunning views.



THE CONSERVATORY

MILKWOOD

Technical Specs

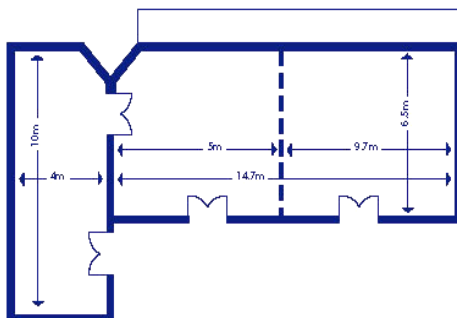

- Permanent AV wiring for PA and projection system.
- Un-interrupted power supply.
- Air-conditioning.
- Floor sockets for power and ISDN lines + wireless access.
- Separate entrances.
- Soundproof partition.
- Adjoining conservatory.

Please don't hesitate to contact our offices on (021) 448 4094.

www.sightnsound.co.za