

**Sight 'n Sound at the  
Town House Hotel**  
Tel: +27 21 448 4094  
bookings@sightsound.co.za  
www.sightsound.co.za

# Mostert



## Conference & Banqueting



With a range of venue options available on two spacious levels, equipped with state-of-the-art audio-visual and presentation aids, the centre is ideally placed to host functions large and small. Thanks to the highly flexible, modular nature of its venues, the centre caters for large theatre style presentations accommodating up to 250 people, conferences and product launches, 'sit-down' functions and banquets, as well as smaller meetings or 'break-away' sessions.

The standard screen configuration includes either a 3.7m x 2.7m (12' x 9') fast fold screen centered on one side with a lectern off center or two 3.0m x 2.3m (10' x 7') screens placed on the outer wall with a lectern in the middle. This can be used as a static docking station for a laptop which includes a goose neck microphone, power outlet, VGA com port projector connection and can be operated by means of remote clicker mouse or by a technician. Virtually all systems can be installed on ceiling trussing enabling the implementation of any floor plan.

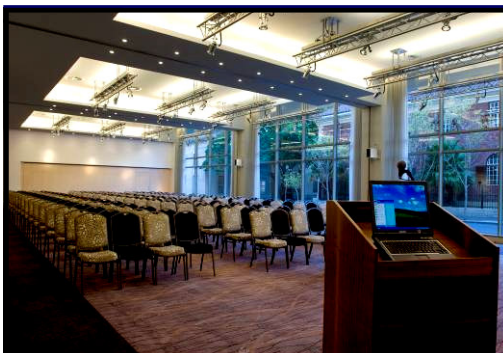
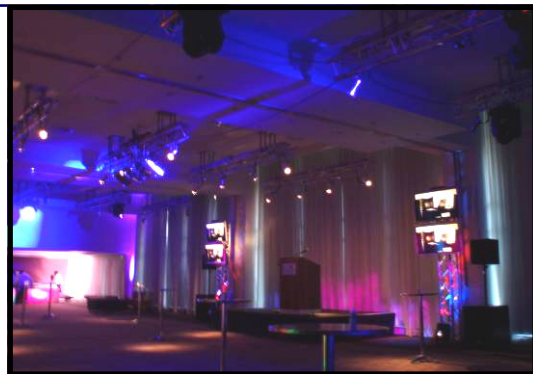

The Ballroom has a semi-permanent AV installation with all wiring for projection, public address and lighting systems imbedded in the venue. With ceiling mounted projectors, profile spots and/or stage lighting it allows for maximum usage of space and an aesthetic finish. All four of the venues speakers are wall mounted and can be positioned in any direction. A comfort monitor of either 19 or 42inch can also be installed. The full AV set-up can be run on a dedicated un-interrupted power supply.

With just under 300 square meters to work with and through its modular design, the Mostert presents some unique opportunities to install an integrated stage set. All of our sets are custom designed and built to your specifications incorporating screens of any size, utilizing rear projection, integrated set and stage lighting with company branding or logo's. The only limitations are in your imagination!

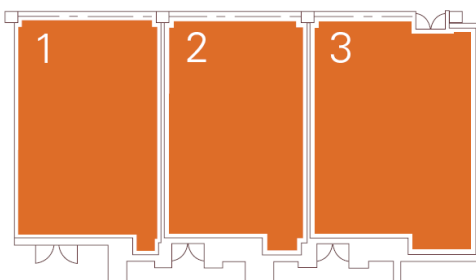
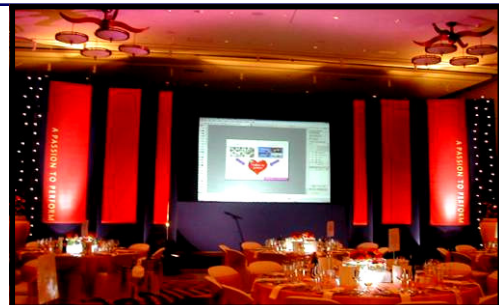

Please don't hesitate to contact our office on (021) 448 4094.

[www.sightsound.co.za](http://www.sightsound.co.za)

### Technical Specs

- Room dimensions: 11.5m x 23m
- Permanent AV wiring for PA, projection and lighting systems.
- Un-interrupted power supply.
- Air-conditioning.
- Floor sockets for power and ISDN lines + wireless access.
- 63amp three phase socket.
- Programmable house lights.
- Lobby entrance.